

# Opportunity Village Eugene



# opportUNITYvillage

---

## EUGENE

“To develop and educate the public about affordable micro-housing solutions for people in life transition, in economic hardship, or seeking a simpler way of life”



# Program

## Agreement with City of Eugene:

City provides site – Nominal Fee

Up to 45 people / 30 dwellings

Conditional Use Permit

OVE cover all operation & maintenance costs

# Program

## OVE Admission

Currently unhoused

Willingness to accept community agreement

Willingness to participate in governance/community activities

Willingness to accept background check

18 or older

# Program

## OVE Rules

No alcohol/drugs/weapons/violence/theft

No persistent disruptive behavior

Community Volunteer/Participatory Requirement

# 111 N Garfield

## opportUNITYvillage EUGENE

Illustrative Plan

111 N. Garfield Street

- |                           |                           |
|---------------------------|---------------------------|
| A. FRONT DESK/ADMIN       | i. INDOOR/OUTDOOR KITCHEN |
| B. STORAGE                | J. DINING AREA            |
| C. BIKE PARKING           | K. COMMUNITY SUPPORT      |
| D. MICRO-BUSINESSES       | L. RESTROOM/SHOWER        |
| E. WORK SPACE             | M. RAISED GARDEN BEDS     |
| F. GREENHOUSE             | N. CONESTOGA HUTS         |
| G. COVERED GATHERING AREA | O. BUNGALOWS              |
| H. DUMPSTERS/COMPOST      |                           |

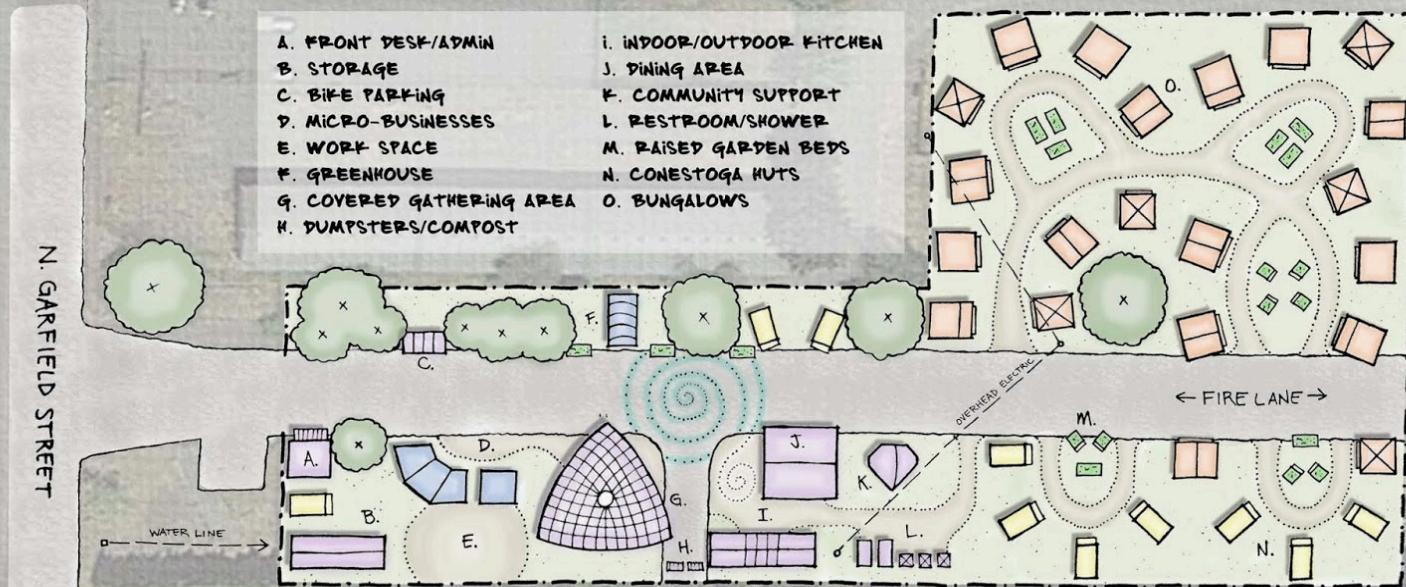

# Dwellings

## Conestoga Huts

- 9 on site
- 60sf



# Dwellings

## Bungalows

- 20 on site
- 64 – 80 sf





## Site

# Community Buildings

- Heated Community Yurt
  - 750 sf
- Restrooms/Shower/Laundry
  - 112 sf
- Kitchen
  - 200 sf



# Resident Data

33 current residents  
58 served to-date

OVE Resident Gender Profile

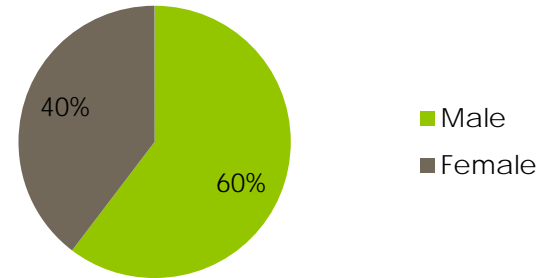

Age	18-24	25-54	55-64	65+
Total # of Residents	1	50	7	0

# Resident Data

12 have transitioned out of OVE

- 9 permanent housing
- 3 transitional

10 left due to violations

All OVE residents from Eugene/Springfield area

Length of Stay	<1 month	1-2 months	3-6 months	7-12 months
Total # of Residents	8 14%	12 21%	20 34%	18 31%

# Resident Data

## Total Number of Disturbances

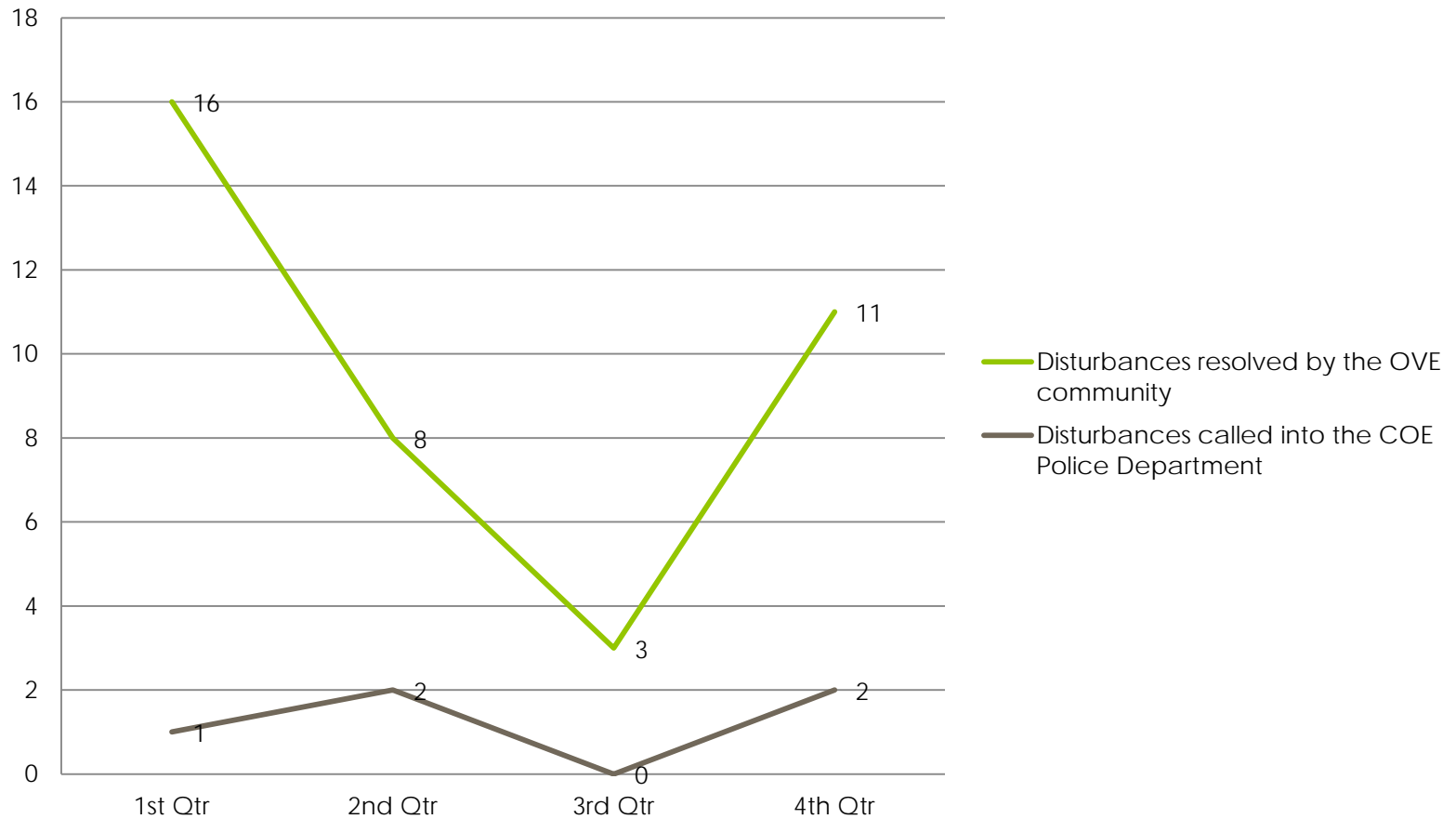

# Publicity

- **OVE In the News:**
  - • USA Today
  - • Associated Press
  - • CNN
  - • PBS
  - • The Global Urbanist
  - • Good Times Weekly
  - • Oregonian
  - • Register Guard
  - • KLCC
  - • Eugene Weekly
- **OVE has attracted visitors (city officials, advocates, or students) with an interest in replicating the model from the following areas:**
  - • Adelaide, Australia
  - • Washington, DC
  - • Dallas, TX
  - • Ann Arbor, MI
  - • Madison, WI
  - • Buffalo, NY
  - • Santa Cruz, CA
  - • Humboldt County, CA
  - • Chico, CA
  - • Los Angeles, CA
  - • Portland, OR
  - • Medford, OR
  - • Roseburg, OR
  - • Ashland, OR

# Recommendation

1 year extension to October 1, 2015

# Council Options

- Authorize the City Manager to extend the City's existing operating agreement with OVE to October 1, 2015.
- Take no action and direct the City Manager to return with additional information.
- Take no action and allow the program to sunset on October 1, 2014.

# Discussion