COUNCIL RESOLUTION NO. 5453

**A RESOLUTION REQUESTING THAT JURISDICTION
OVER PORTIONS OF CROW ROAD, GREENHILL ROAD,
AND LA PORTE DRIVE BE TRANSFERRED TO THE CITY
OF EUGENE.**

PASSED: 8:0

REJECTED:

OPPOSED:

ABSENT:

CONSIDERED: July 14, 2025



RESOLUTION NO. 5453

A RESOLUTION REQUESTING THAT JURISDICTION OVER PORTIONS OF CROW ROAD, GREENHILL ROAD, AND LA PORTE DRIVE BE TRANSFERRED TO THE CITY OF EUGENE.

The City Council of the City of Eugene finds that:

A. The City Council finds it expedient and in the best interests of the City to acquire jurisdiction over portions of the following county roads as particularly described in Exhibit A attached to this Resolution and incorporated herein by reference, all of which lie within the corporate limits of the City of Eugene: County Road No. 988 (Crow Road), County Road No. 36 / 465 (Greenhill Road), and La Porte Drive (no County Road number).

B. The Board of County Commissioners of Lane County, Oregon has authority under provisions of ORS 373.270 to release jurisdiction over county roads within the limits of the City of Eugene and should be requested to do so.

NOW, THEREFORE,

BE IT RESOLVED BY THE CITY COUNCIL OF THE CITY OF EUGENE, a Municipal Corporation of the State of Oregon, as follows:

Section 1. In accordance with ORS 373.270(6), the City of Eugene hereby requests that Lane County take action in accordance with ORS 373.270 to surrender jurisdiction to the City of Eugene the portions of the following county roads that are described and depicted in Exhibit A attached to this Resolution, all of which lie within the corporate limits of the City of Eugene: County Road Nos. 988 (Crow Road) and 36 / 465 (Greenhill Road), and La Porte Drive (no County Road number).

Section 2. Upon its passage, the City Manager shall forward a copy of this Resolution to the Lane County Administrator for consideration by the Lane County Board of County Commissioners, seeking final Board action in response to this request.

Section 3. Upon adoption of an order of the Board of County Commissioners of Lane County surrendering jurisdiction of any or all of the above described portions of county road, the full and absolute jurisdiction over that portion of road for all purposes of repair, construction, improvement, and the levying and collection of assessments therefor, shall vest in the City of Eugene and the City shall have the same jurisdiction over the road or portion thereof as by its charter, and the laws of the state are given or granted it over any of the public streets and alleys of the City.

The foregoing Resolution adopted the 14th day of July, 2025.



City Recorder

Right of Way Jurisdiction Transfer Requests of Annexed County Roads to the City of Eugene July 14, 2025

CROW ROAD (COUNTY ROAD NO. 988)

Beltline OR 069 (West 11th Avenue) to Crow Road Connector

<u>LEGAL DESCRIPTIONS</u>	<u>MILEAGE</u>
A strip of land 60.00-feet in width lying 30.00-feet on both sides of the centerline of Crow Road, County Road No. 988, in the NW1/4 and the SW1/4 of Section 32, Township 17 South, Range 4 West, of the Willamette Meridian, Lane County, Oregon; the centerline and widths in feet being described as follows:	0.64 miles
Beginning at a point that marks the Centerline Station 0+00.00, said station being a found 2-3/4-inch brass cap stamped "Lane County Surveyors Office T17S, R4W 1/4 S32/S33 2000" per Lane County Index No. 13801; thence along the East-West center of section line, North 87°16'23" West 5300.80 feet to a found mag nail with washer stamped "Lane Co Survey 1/4 2012" marking the West 1/4 corner, per Lane County Index No. 15525, of said Section 32, said point being Centerline Station 53+00.80 and there ending, all within Lane County, Oregon.	

The widths in feet of the strip of land herein described are as follows:

<u>STATION TO STATION</u>	<u>WIDTH ON NORTHERLY SIDE OF CENTERLINE</u>
21+43.96 to 53+00.80	30.00
<u>STATION TO STATION</u>	<u>WIDTH ON SOUTHERLY SIDE OF CENTERLINE</u>
16+75.14 to 53+00.80	30.00

EXCEPT: All the portion of right of way within the existing right of way OR 126.

Bearings are based on the Oregon Coordinate System NAD 83(91) – South Zone.

GREENHILL ROAD (COUNTY ROAD NO. 36/465)

Beltline OR 069 (West 11th Avenue to Eugene's Urban Growth Boundary)

<u>LEGAL DESCRIPTIONS</u>	<u>MILEAGE</u>
A parcel of land lying in the NE1/4 of Section 31 and the NW1/4 of Section 32, all in Township 17 South, Range 4 West, Willamette; said parcel being a strip of land variable in width on each side of the centerline of Greenhill Road (County Road 36/465), which centerline is more particularly described as follows:	0.11 miles
Beginning at point that marks the Centerline Station 0+00.00, said station being on the center line of Beltline OR 069 (West 11 th Avenue), said point bears North 1,182.59 feet and East 4.36 feet from a found mag nail with washer stamped "Lane Co Survey 1/4 2012" marking the West 1/4 corner, per Lane County Index No. 15525, of said Section 32; Thence South 1°08'31" W 440.41 feet; thence along a 954.93-foot radius curve to the right (the long chord of which bears South 7°08'38" West 199.70 feet) 200.07 to Center Line Station 6+40.48 and there ending, all within Lane County, Oregon.	

The widths in feet of the strip of land herein described are as follows:

STATION TO STATION

0+00.00 to 0+77.26
0+77.26 to 0+99.97
0+99.97 to 6+25.65

WIDTH ON EASTERLY SIDE OF CENTERLINE

0.00 to 89.00
89.00 to 50.00
50.00

STATION TO STATION

0+00.00 to 0+21.36
0+21.36 to 0+92.40
0+92.40 to 0+46.40
0+46.40 to 2+20.31
2+20.31 to 2+19.22
2+19.22 to 5+00.00
5+00.00 to 6+40.41

WIDTH ON WESTERLY SIDE OF CENTERLINE

0.00 to 55.71
55.71 to 8.07
8.07 to 9.10 East of Center Line
9.10 East of Center Line to 7.62 East of Center Line
7.62 East of Center Line to 35.00
35.00 to 30.00
30.00

EXCEPT: All the portion of right of way within the existing right of way of OR126.

Bearings are based on the Oregon Coordinate System NAD83(91) – South Zone.

LA PORTE DRIVE (LANE COUNTY LOCAL ACCESS ROAD- NO COUNTY ROAD NO.)

Crow Road to the End

LEGAL DESCRIPTIONS**MILEAGE**

A strip of land 50.00-feet in width lying 25.00-feet on both sides of the centerline of La Porte Drive, Lane County Local Access Road, in the SW1/4 of Section 32, Township 17 South, Range 4 West, of the Willamette Meridian, Lane County, Oregon; the centerline being more particularly described as follows:

0.40 miles

Beginning at a point that marks the Centerline Station 10+00.00, said station being on the centerline of Lane County Road 988 (Crow Road) and bears North 2658.53 feet and West 131.43 feet from the South 1/4 corner of Section 32, Township 17 South, Range 4 West, Willamette; thence South 1°39'24" West 1831.82 feet; thence North 86°55'34" West 331.90 to centerline Station 31+63.72 and there ending, all within Lane County, Oregon.

EXCEPT: All the portion of right of way within the existing right of way of Crow Road.

Bearings are based on the Oregon Coordinate System NA83(91) – South Zone.

CROW RD TO BE TRANSFERRED

N.E.1/4 SEC. 31 T.17S. R.4W. W.M.,
 N.W.1/4 SEC. 32 T.17S. R.4W. W.M.,
 N.E.1/4 SEC. 32 T.17S. R.4W. W.M.,
 S.E.1/4 SEC. 31 T.17S. R.4W. W.M.,
 S.W.1/4 SEC. 32 T.17S. R.4W. W.M. &
 S.E.1/4 SEC. 32 T.17S. R.4W. W.M.
 Eugene, Lane County, Oregon



NO SCALE

Legend



Annexed Road Segment to
be Transferred



Eugene City Limits

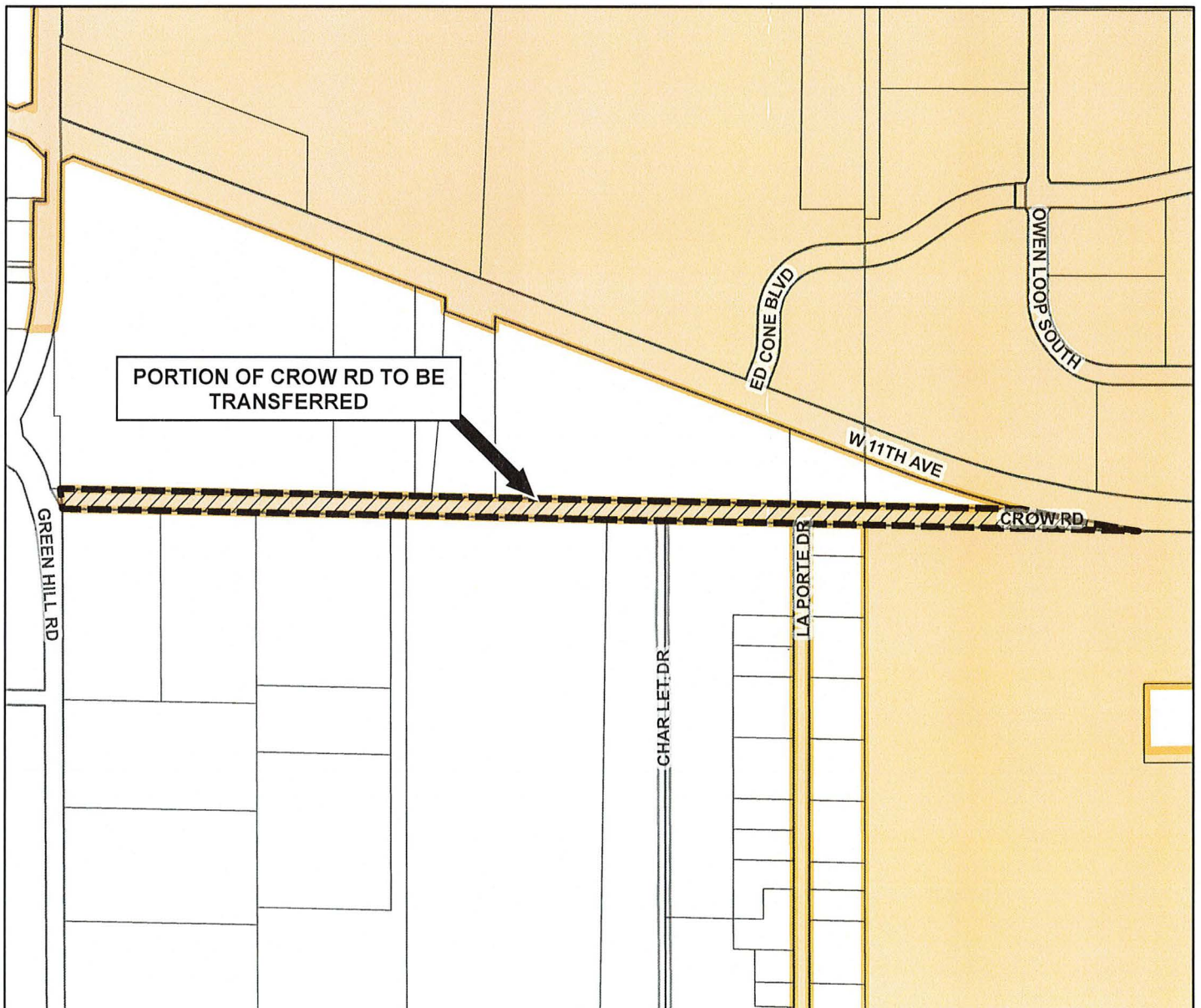
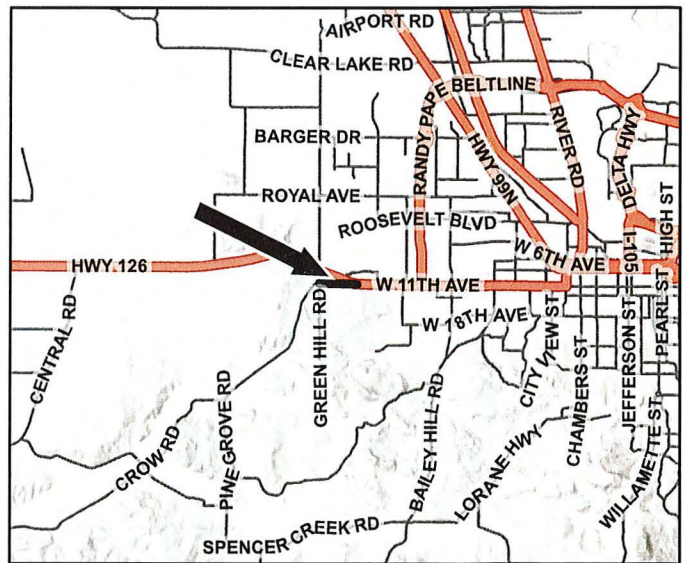

SR2505_0797

N.E.1/4 SEC. 31 T.17S. R.4W. W.M. &
N.W.1/4 SEC. 32 T.17S. R.4W. W.M.
Eugene, Lane County, Oregon



Annexed Road Segment to be Transferred



Eugene City Limits

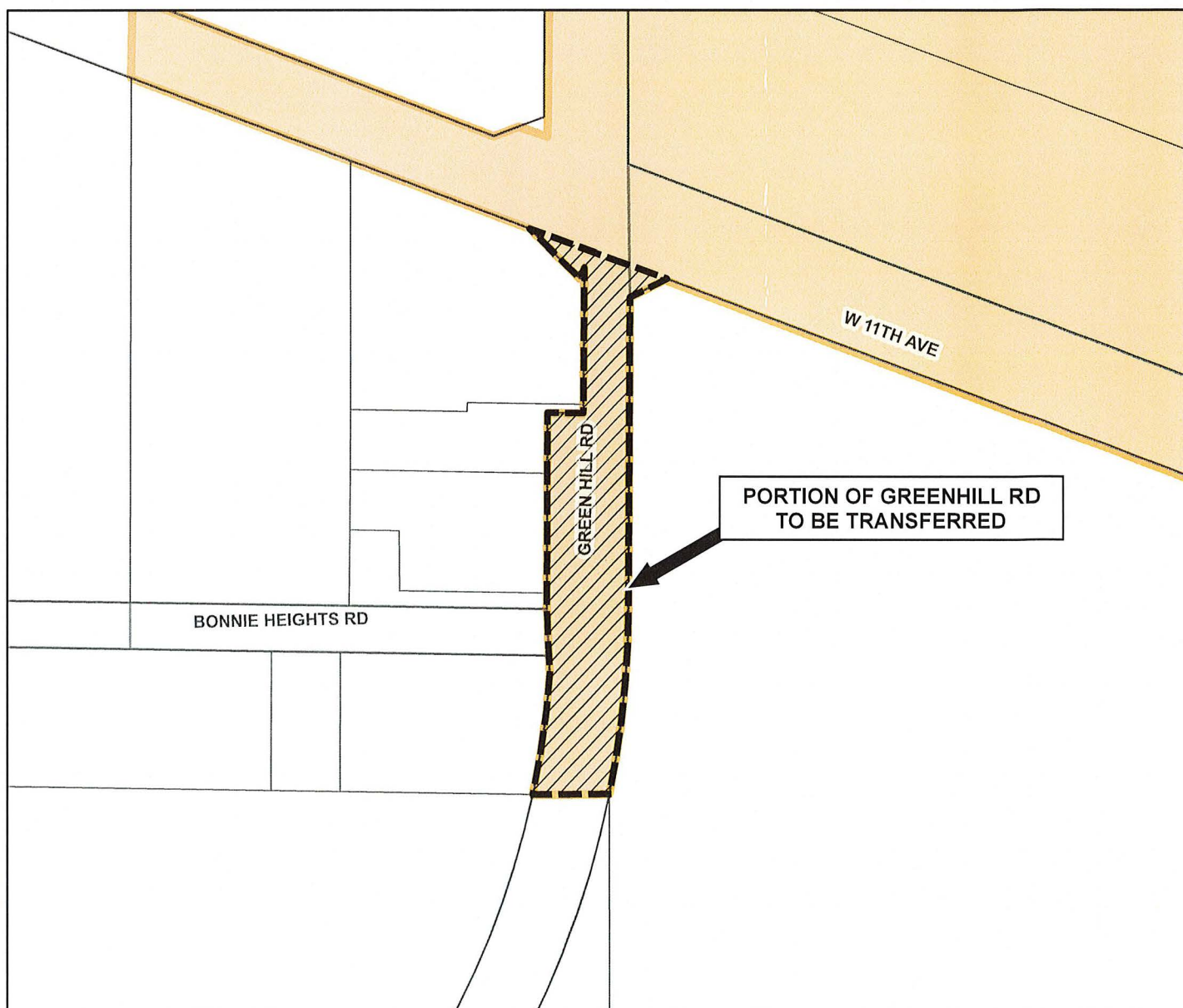
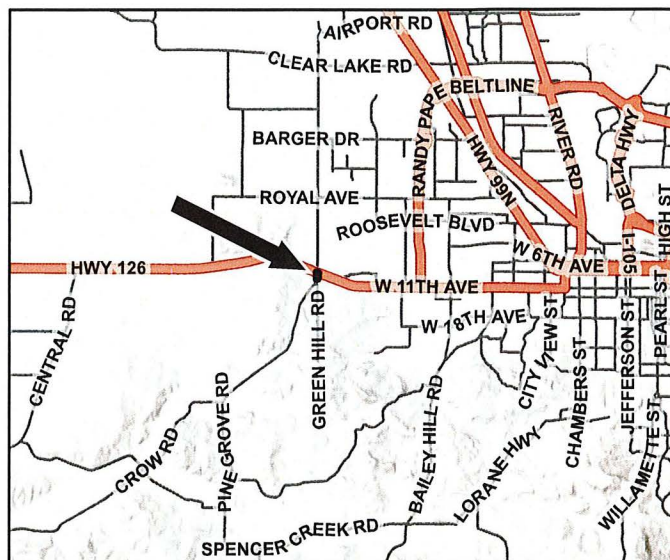



LA PORTE DR TO BE TRANSFERRED

S.W.1/4 SEC. 32 T.17S. R.4W. W.M.
Eugene, Lane County, Oregon



Legend

 Annexed Road Segment to be Transferred

 Eugene City Limits

